

14 Advertising



The Big London ENERGY SWITCH

Waltham Forest Council is supporting a scheme to help see if residents can get a better deal on their gas and electricity bills

You may be paying too much for your gas and electricity!

- How does the scheme work?**
The Big London Energy Switch is a collective switching scheme run by Waltham Forest Council and a number of other councils in London.
- By gathering together a large number of people who want to lower their gas and electricity bills, the Big London Energy Switch, using a third party 'switching provider', can encourage energy companies to offer their lowest prices.
- Once registration is closed, all the energy companies are invited to offer their best prices to everyone who registered.
- You will then receive details of exactly how much money you could potentially save by switching.
- You can choose whether or not to accept the offer.

How much can I save?
Savings depend on how much energy you use and the price of your current tariff.

There is **no guarantee** the switch will save you money. For example if you have recently switched supplier you may already be on the best value tariff. You are under no obligation to accept the offer. A similar scheme has seen yearly savings of £40 to £250 per household, so there is nothing to lose by registering.

Can I take part?
Anyone who pays a household energy bill can take part, although if you are in debt to an energy company you may not be allowed to switch.

When is the switch happening?
You can register your interest now. Registration is open and will close on **13th October** with offers to customers expected from the 24th October.

To find out more or to register go to
www.walthamforest.gov.uk/pages/events/the-big-london-energy-switch.aspx



Walthamstow SCHOOL FOR GIRLS

OPEN EVENING

Thursday 16th October 2014 6-8pm



'There is a strong focus on excellent academic outcomes'
'Inclusive care for individuals lies at the heart of the school's ethos'

OFSTED

To find out more visit www.wsfg.waltham.sch.uk

Leytonstone Library Improvement works beginning!

The library will be closed from Monday 20 October 2014 until September 2015

- We are investing in the library to:
- Modernise the space
 - Create flexible spaces to accommodate a wide range of activities and events
 - Upgrade the ICT and provide faster internet access with high-quality printing and photocopying facilities
 - Provide a comprehensive range of children's, teenage and adult book stock which meets local needs

Alternative library:

During the work at Leytonstone Library your nearest alternative library will be the Leyton Library Plus, High Road, Leyton E10 5QH.
Monday-Friday 9am-7pm,
Saturday 9am-6pm and Sunday 12pm-4pm.

For more information please visit www.walthamforest.gov.uk/libraries or call **020 2496 3000**

Or visit the Harrow Green Community Library run by volunteers at the Epicentre, 41 West Street E11 4LJ.
Saturday 11am-2pm,
Monday 11am-4pm
and Thursday 3pm-7.30pm see <http://harrowgreenlibrary.wordpress.com/>



Leytonstone Library to be transformed

- Library refurbishment will provide better facilities and access to more Council services
- Leytonstone Library Plus is planned to reopen in September 2015

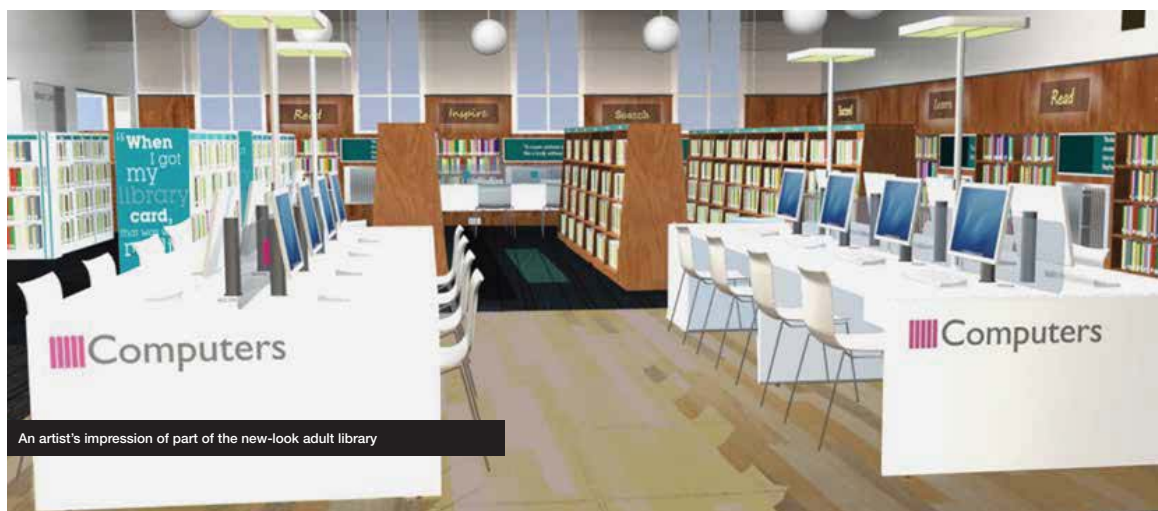

An artist's impression of part of the new-look adult library

Works to transform Leytonstone Library into a fantastic new Library Plus branch will begin in November, with the building set to close to residents on Monday 20 October.

The refurbished library will boast modern IT facilities with superfast access to the internet, and free wi-fi, along with a new children's library that includes new shelving and a storytelling area. There will also be an improved adult section and a dedicated space for teenagers, with books for young adults, a study area and computers. New books will also be bought to meet local demand.

More services

As well as creating better facilities, the new Library Plus will offer easier access to a range of Council services. Residents will be able to pay Council Tax, make pre-booked appointments to register a birth, receive advice about benefits and local services and much more.

Because English Heritage has designated Leytonstone Library as a Grade II* listed building, the original

listed features such as the terrazzo, timber panelling, bookcases and significant original furniture will be retained, and there will be no major alterations made to the external fabric of the building.

The ground floor will be opened up to offer a flexible cultural and ICT space which will feature regularly changing local art exhibitions, as well as offering the opportunity to access free wi-fi and use PCs for research and study.

The upstairs foyer area will feature display cabinets, information leaflets to residents and self-service kiosks where you can check out or return books, pay fines for overdue books and use self-service PCs to pay Council Tax or apply for parking permits and housing benefit.

A new, improved children's library will feature a fun crawl-through tunnel and white and lime furniture as used at Leyton Library Plus.

Additional shelving, featuring quotes from celebrated authors and literary works, will also be installed in the adult library and the layout

simplified. New signage throughout the library will make it quick and easy to find the books, reference materials or IT facilities that you are looking for.

A special teenage study area will include a range of new learning materials, new ICT equipment, white furniture and tables to study alone or with classmates.

Nearby facilities

Leytonstone Library will be closed to the public while the refurbishment works take place and is expected to re-open in September 2015. During this period residents can explore two other library facilities available nearby.

Leyton Library Plus (High Road Leyton, E10 5QH), which was fully refurbished this year, is just over a mile away so why not take a brisk walk or a short bus ride and see the fantastic facilities on offer.

It is open on weekdays from 9am to 7pm, on Saturdays from 9am to 6pm, and on Sundays from 12noon to 4pm.

Also nearby is The Harrow Green

Community Library (The Epicentre, 41 West Street, E11 4LJ) which is run by a dedicated group of local volunteers. It is open on Mondays from 11am to 4pm, on Thursdays from 3 to 7.30pm and on Saturdays from 11am to 2pm.

Both sites offer a mixture of adult and children's books.

Leytonstone Library Plus will reopen with a special celebration event in September 2015. Keep an eye out for more information about how the works are progressing. A slideshow about the improvement works and architects' impressions are also available to view on the Council website.

More info

For more information about Library Plus and the works taking place at Leyton Library please visit www.walthamforest.gov.uk/libraries or phone the Library Development team on **020 8496 3000**. For more information on Harrow Green Community Library visit www.harrowgreenlibrary.wordpress.com or phone **07460 800 229**.

In brief



The Hoe Street pop-up shop in Walthamstow

Pop-up shop

A new array of businesses are taking up residence at the pop-up shop in Hoe Street, Walthamstow, with a dozen new start-ups lined up to show off their wares through until the end of May.

The pop-up shop initiative allows residents the opportunity to pitch an idea for a business and apply for temporary rent-free space in a town centre location – giving them the chance to see how viable the idea proves to be.

An independent bookshop, a florist and gift shop, a vinyl record shop, a renovated and recycled furniture shop and a vintage fashion outlet have all successfully applied to use the space. SPACE – a Board Game Community Cafe, with regular events suitable for adults and families, will be the next outlet to open its doors between Tuesday 7 and Sunday 26 October.

The Council is also now considering applications from prospective business owners who would like to occupy a pop-up shop unit at 76 Old Church Road, Chingford, so if you've got a good idea get in touch.

• For more information about the businesses that will be featuring at the Hoe Street shop or to apply for a slot at the Old Church Road unit, visit www.walthamforest.gov.uk/loveyourhighstreet. Free internet access is available at all libraries in the borough.

Women of the Year

Waltham Forest residents Leyla Hussein and Nimco Ali, who co-founded not-for-profit organisation Daughters of Eve, have been named as Red magazine's Women of the Year in the community and charity sector.

Daughters of Eve was founded in 2010 to help protect the rights of girls living in communities that practise female genital mutilation (FGM). The pair, alongside fellow resident and anti-FGM campaigner, Hibo Wardere, were also invited to speak at July's Girl Summit, the UK's first anti-FGM conference. Home Secretary Theresa May announced the creation of a £1.4million National FGM Prevention Programme, better policing and anonymity for victims.

• For more information on Daughters of Eve visit www.dofeve.org. Free internet access is available at all libraries in the borough.